

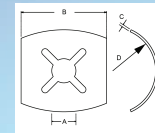

Starlock® Push-On Fasteners Tube clip Type

A		B	C	D
Shaft size	Part No:	Length	Material Thickness	Tube size
1/8"	8015	5/8"	.016"	1/2"
5/32"	7132	5/8"	.016"	5/8"
3/16"	7117	5/8"	.016"	1/2"
3/16"	7111	5/8"	.016"	5/8"
3/16"	8098	7/8"	.016"	5/8"
3/16"	8112	5/8"	.016"	3/4"
1/4"	8107	.630"	.016"	.630"
1/4"	8127	5/8"	.016"	3/4"



This Starlock® was designed to eliminate the use of rivets in the manufacture of tubular furniture and similar applications. It will be noted that the radius of the form is slightly less than the outside diameter of the tube, so that when the Starlock® is assembled it fits snugly to the contour of the tube and assembly is under a degree of tension.

All dimensions shown are subject to engineering tolerances.

These fasteners can be supplied in blue and varnish BV or in mechanical zinc plated DT finishes.

Starlocks® are generally available in spring steel and many supplied in stainless steel.

Non-standard parts may be subject to a minimum order quantity.

Baker & Finmore Ltd, 199 Newhall Street, Birmingham, B3 1SN, United Kingdom

UK Tel: +44 (0) 121 236 2347 Fax: +44 (0) 121 7224 e-mail: sales@bakfin.com

www.bakfin.com

www.starpress.co.uk